

Subject Property

Entire Area is Characterized by Row Dwellings

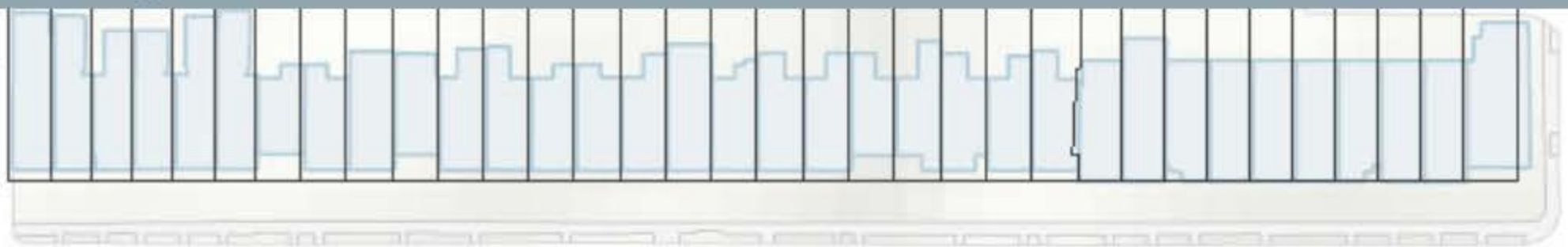



V St NW

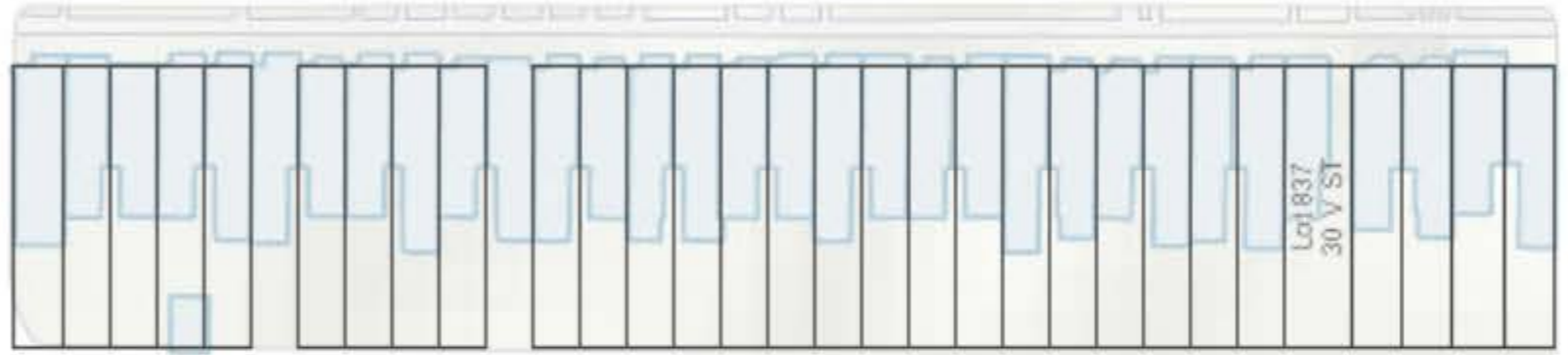

Lot 837
30 V ST



Lot 46
15-77 U STR

RF-1

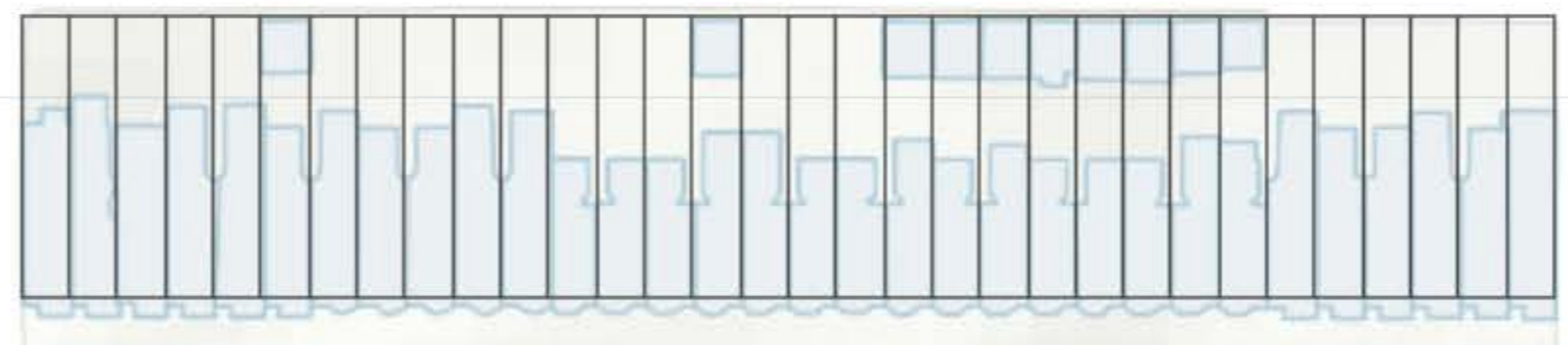

U St NW

properties to the east- all row dwellings

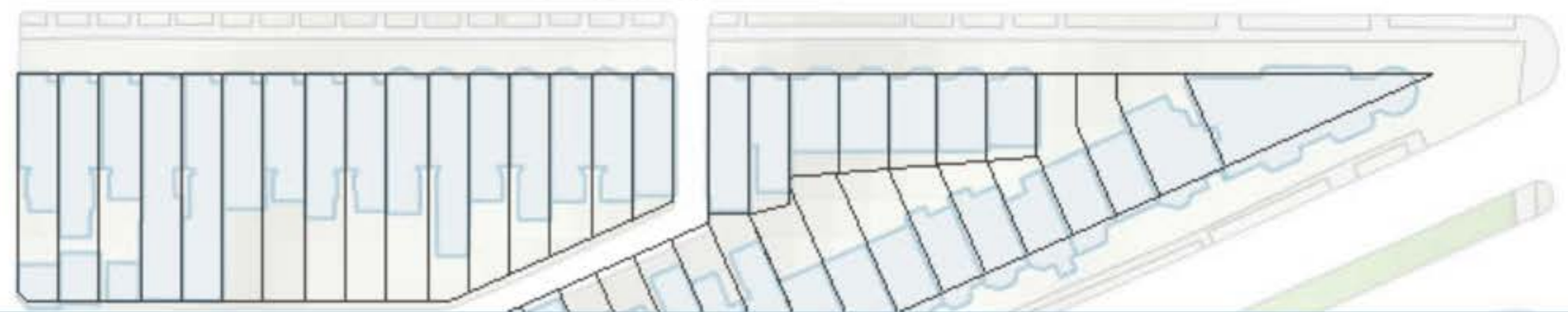

Lot 801
2201 NORTH CAPITOL ST
R-3

V St NE

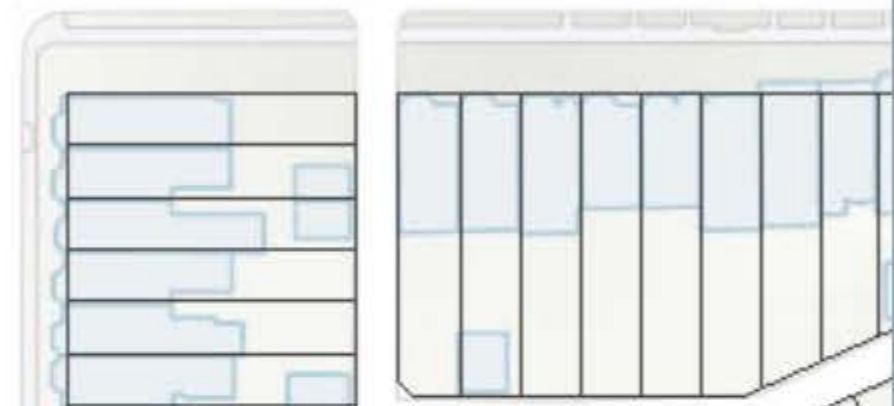

Lot 802
2 RHODE ISLAND AV

U S

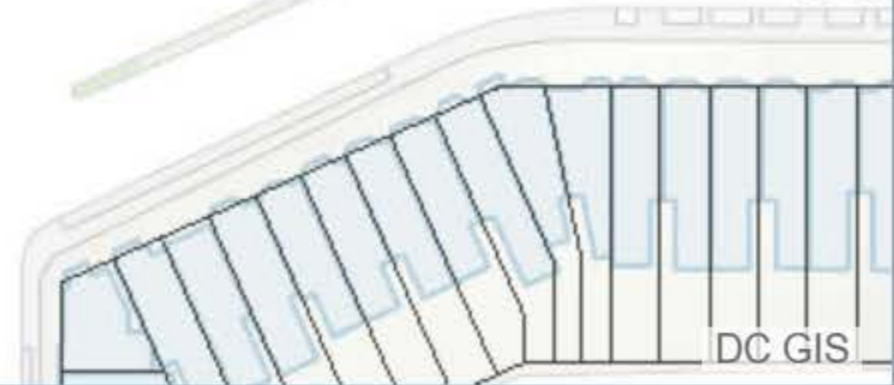

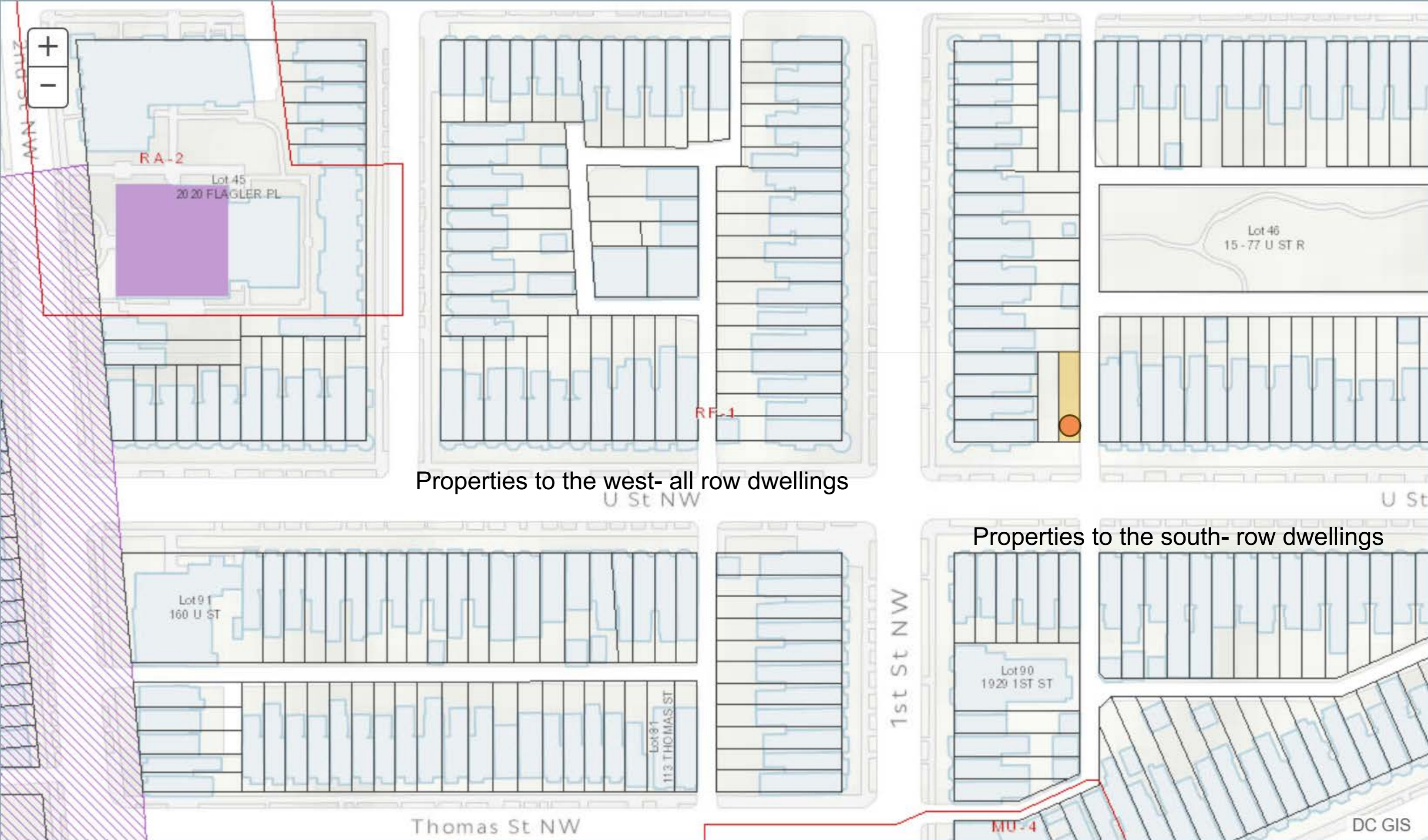

Properties to the west- all row dwellings

Properties to the south- row dwellings

Thomas St NW

1st St NW